



Catalog No. MI-101
Storage: Room Temperature

Swab Collection Kit Manual

The All-in-One
Diagnostic Test
for Infectious Diseases for
All Animals

MiDOG

Animal Diagnostics

Customer Support:

(833) 456-4364 or (833) iLMiDOG
info@midogtest.com | www.midogtest.com

Orders:

orders@midogtest.com | www.midogtest.com/orders

The information contained in this MiDOG® report is intended only to be factor for use in a diagnosis and treatment regime for the canine patient. As with any diagnosis or treatment regime, you should use clinical discretion with each patient based on a complete evaluation of the patient, including history, physical presentation and complete laboratory data, including confirmatory tests. All test results should be evaluated in the context of the patient's individual clinical presentation. The information in the MiDOG® report has not been evaluated by the U.S. Food and Drug Administration.

CAUTION: Urine Conditioning Buffer™ preservation reagent is provided in the urine collection tube. DO NOT drink, touch, or remove the preservation reagent from the swab collection tube. The preservation reagent is an irritant to the skin and eyes. Do not ingest preservation reagent; avoid contact with skin and eyes; wash with water for 20 minutes if exposed to skin or eyes. Do NOT induce vomiting if the preservation reagent is ingested. Obtain appropriate medical attention in the event of any exposure. Keep out of reach of children.

Clear Plastic Bag

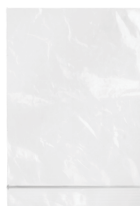

Sample Information Card



Kit Components

Swab Collection Tube & Sterile Swab



Return Envelope with Prepaid Label



Swab Collection Kit – Instruction Manual

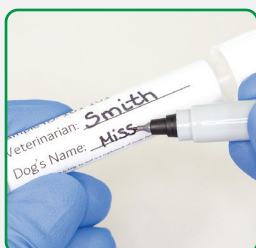

1. Label swab collection tube with the names of the veterinarian and the animal.



2. Wearing gloves, carefully remove the swab from the package, touching only the plastic end of the swab.

Note: Always sample using a dry swab.

Any type of sample can be submitted. Please select an appropriate sample based on the type of infection the animal is experiencing. Below are some sampling examples:

Skin



3A. Press the swab directly onto the skin. Maintain moderate pressure while moving/twirling the swab in the area 10 times.

Ear

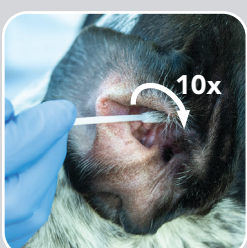

3B. Carefully twirl the swab in the ear canal, pressing gently against sides. Twirl 10 times. Remove without contacting the skin.

Feces



3C. Stick swab into the animal's feces, twirl, and remove to collect a sample. Do not cover the entire tip! A pea sized amount of feces should be sufficient.

Body Fluids (Other than Urine)



3D. Any animal deprived fluid sample can be tested. Examples are bile, joint fluid, sputum, BAL, cytology samples, fine-needle

aspirations, and washes/rinses (e.g., eye washes, nasal washes). A minimum of 2 ml of liquid is required for testing, but 4 ml is ideal to ensure accuracy of the results. Fluid must be mixed in directly to the sample collection tube and must not be a swab soaked in the liquid.

Note: For urine samples, please use the **MiDOG Urine Collection Kit** for optimal accuracy.

Note: Use one swab for each collection site depending on the type of infection. If needed, multiple samples can be taken from an individual patient.

Continue (Steps 4-9):



4. Place swab head with sample directly into the solution at the bottom of the swab collection tube.



5. Break off the plastic handle of the swab half-way at the breakpoint. Discard handle.



6. Screw the cap securely onto the swab collection tube. Ensure the tube is sealed tightly to prevent leakage.



7. Shake the swab collection tube 10 times to fully cover the swab with solution.



8. (A) Place collection tube into the biohazard bag. (B) Place the biohazard bag into the prepaid envelope.

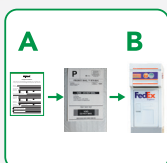

9. (A) Fill out Sample Information Sheet and add to prepaid envelope, or log into your account at www.midogtest.com to provide sample information. (B) Drop the return envelope off at your FedEx location within 1 year of sample collection.

After the sample is received, your MiDOG® Report will be sent to the email address you provided within 2 to 5 business days. The report will also be accessible through your MiDOG portal.